

Combles 1/25

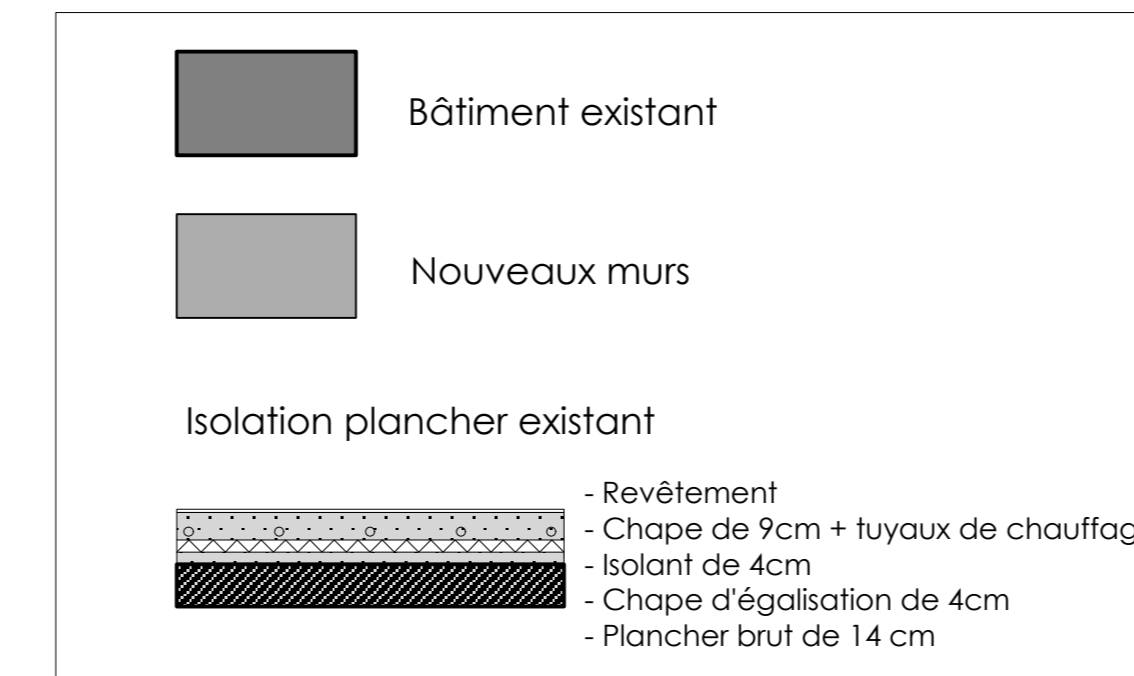

**Luminaire :**

**Suspensions Shadows BROKIS**

- 10,8 cm - 5W
- 18 cm - 6W
- 25 cm - 7W

**Prologue 80 in-Line KREON (1:8cm)**

- Prologue 80 profile Lx80
- Prologue 80 in-Line/in-Dalma double 2x 50W (7,5/15)
- Prologue 80 in-Line/in-Dalma single 50W (7,5/7,5)

**Suspensions TossB U-light 1800/40/60**

**Suspensions ex.1 Fuse Big**

- 12 x H25 max 45W
- 25 x H24 max 40W

**Suspensions Beat Lights TOM DIXON**

- Beat Light - Stout White
- Beat Light - Fat White

- Bandeau LED rigide RGB 15 Led

Ⓢ Eclairage de sécurité

Ⓢ Eclairage de sécurité : Pictogramme

⏏ Interrupteur simple direction

⏏ Interrupteur double direction

**Suspensions Muffins Wood BROKIS**

- 03B - 40W - E27 - 120V
- 06 - 40W - E14 - 240V
- 04 - 60W - E27 - 120V

**Spots encastrés Down 55 KREON**

- 80x74 - 50W

**Spots encastrés Aplis 80 KREON**

- 95 - 50W

**Spots encastrés Doze square wall MODULAR**

- 80x80x53

**Appliques U shapes MODULAR**

- ⊠ 50W max tranfo incl.

VECTORWORKS EDUCATIONAL VERSION

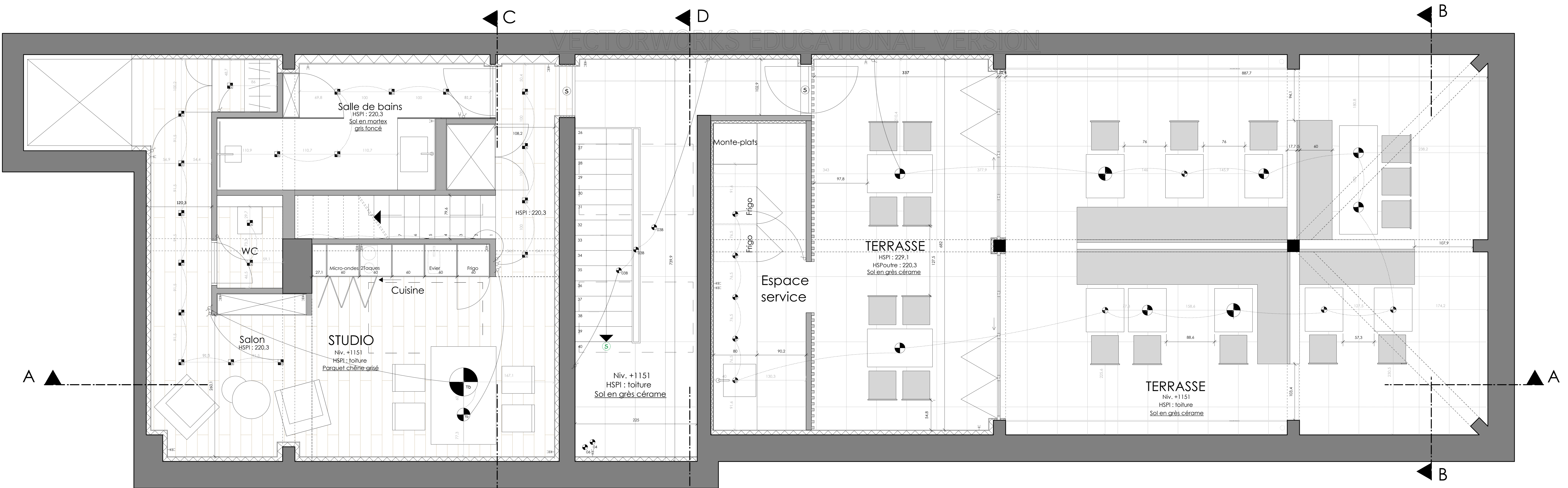

3ème étage 1/25